

VISTA LATERAL

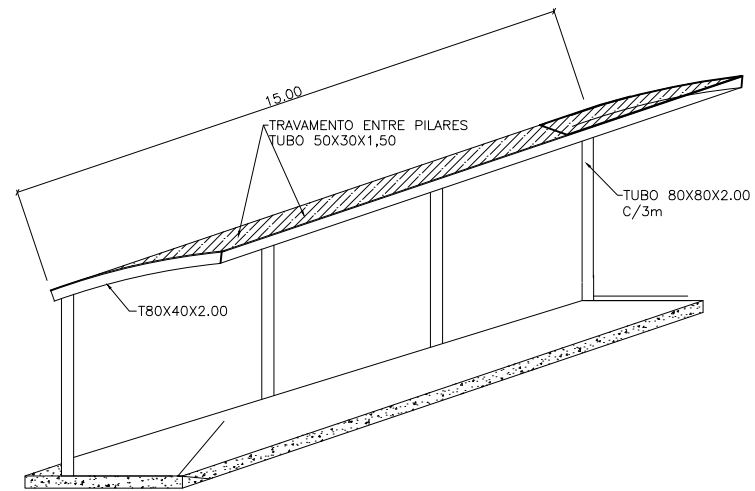

VISTA 3D

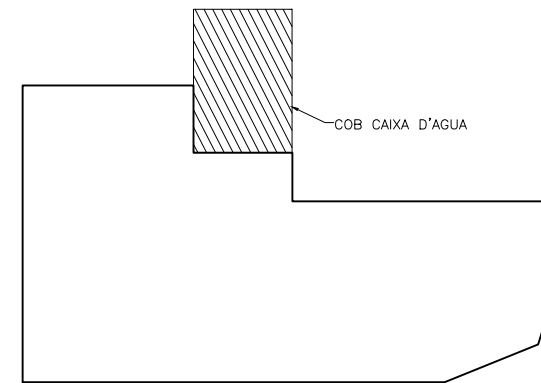

PLANTA DOS TELHADOS

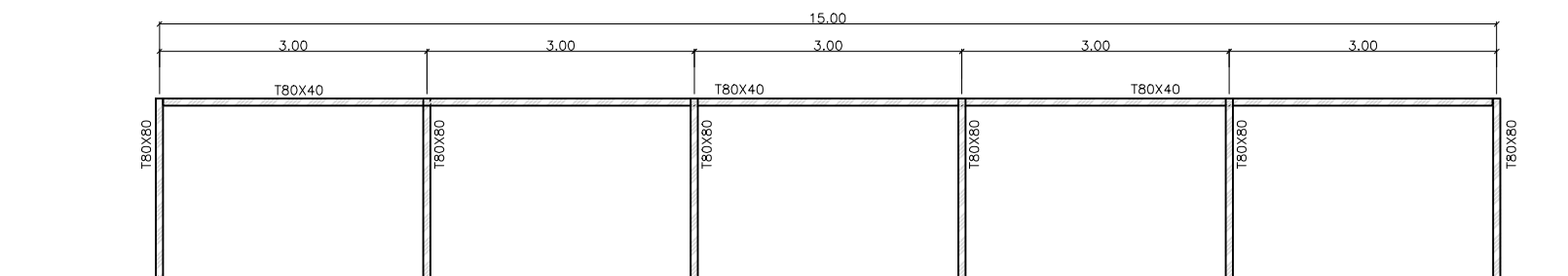

BASE DE 20X20  
FIXADA COM 04 CHUMB PARABOLT 10mm

VISTA FRONTAL

PARADA DE ONIBUS

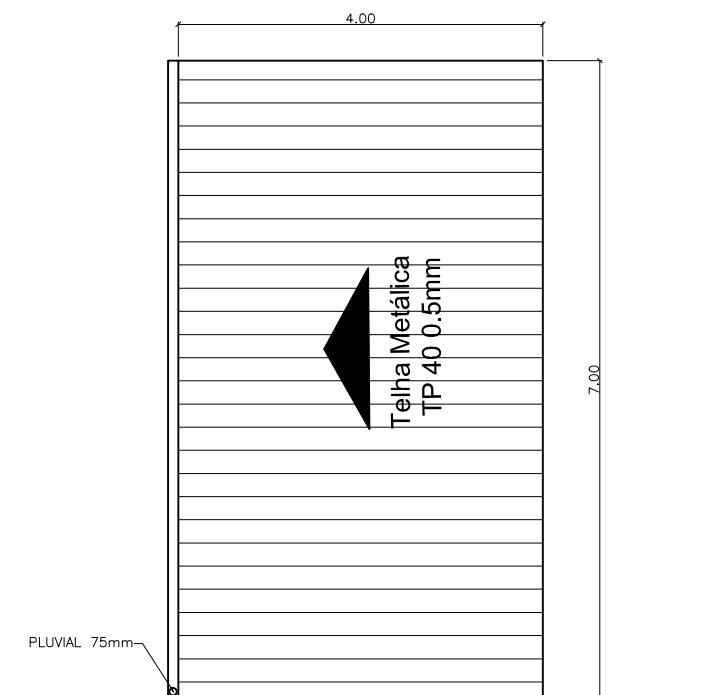

COBERTURA CAIXA D'AGUA

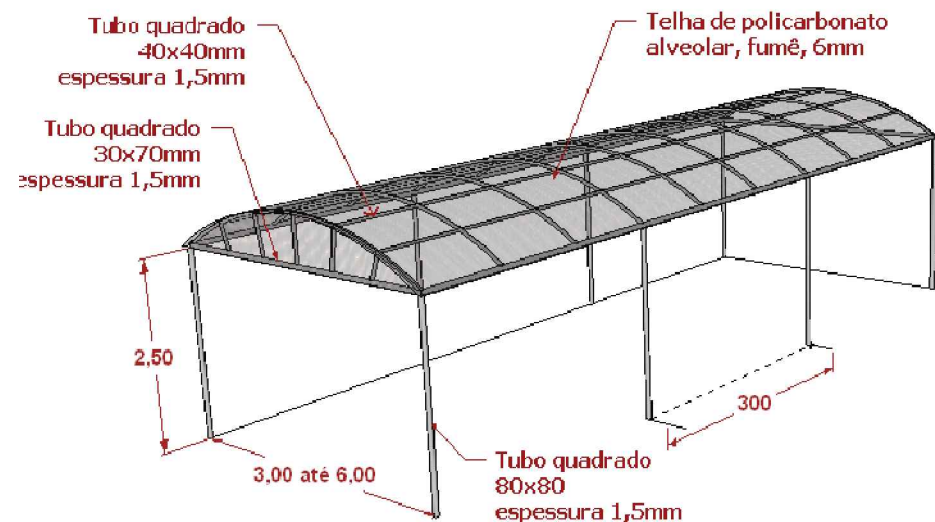

COBERTURA DE ACESSO EM POLICARBONATO

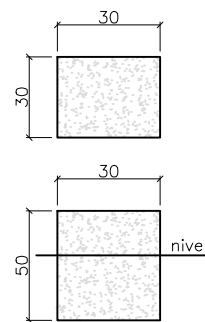

DETALHE BASES DE COCNETO

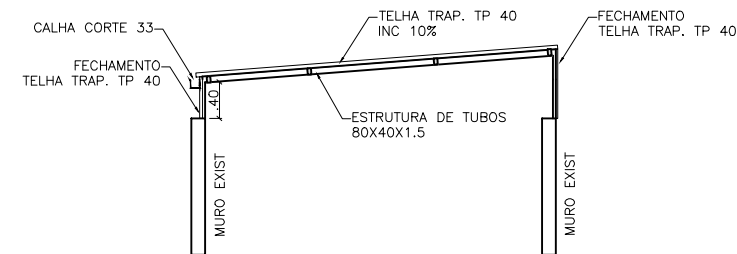

MUNICIPIO DE SÃO JORGE-RS

CNPJ:91.566.851/0001-51

DANILO SALVALAGGIO  
PREFEITO MUNICIPAL

OBRA: REFORMA DO TELHADO E COBERTURAS DA ESCOLA

ENDEREÇO: ESCOLA EMEF PE. BENICIO TAMAMNINI

DESCRIÇÃO: PLANTA BAIXA E DETALHES

ÁREA: 533,50 m2

ESCALA: IND

DATA: 19/02/2024



ANEXO I-B

RESP. TÉCN: AUGUSTO BEN  
CREA-RS 236427

DESENHO: AUGUSTO	REVISÃO: 00	DATA: 19/02/2024
DESENHO:	REVISÃO:	DATA:
DESENHO:	REVISÃO:	DATA:

FOLHA:  
02/02